

ATLAS DOS Series of Progressive Cavity Metering and Dosing Pumps offers an ideal solution to many low-flow pumping applications that require high accuracy in volume control at an affordable price.

For liquids that are low-viscosity to high-viscosity and abrasive liquids it provides a pumping solution that is much more reliable than other types of metering pumps available on the market today.



EAC CE

The ATLAS DOS pump series offers all the benefits in an accurate metering pump in a close-coupled design.

This enables you to have a more compact pump package where space is at a premium.

It also eliminates the need for a baseplate, coupling, coupling alignment, and coupling guard.

Available in 2 sizes.

Technical data

Flowrate : Up to 1300 L/h

Pressure up to : 12 Bar

Features

- ▶ Accurate Flow
- ▶ Close Coupled
- ▶ No Pulsation
- ▶ No Check valves
- ▶ Fits in Small Spaces
- ▶ Handles high discharge pressures
- ▶ Reversible pumping direction

The ATLAS DOS metering Progressing Cavity Pump offers you:

- ▶ Gentle product handling
- ▶ Easy service ability
- ▶ Robust and compact block construction
- ▶ Standard mechanical seal

Basic pump characteristics

Construction Materials:

Body Pump: Stainless steel 316

The rotating parts are in Stainless steel 316

Seal: Mechanical Seal Sic/Sic/FKM or EPDM, Cer/Graph/FKM or EPDM

Stator: NBR, EPDM, HYPALON, FKM

Rotors : AISI 316

Industry Uses

- Rendering Waste Treatment Applications
- High Accuracy Polymer Feed Pumping
- Sampling / Dosing Application
- High Accuracy Polymer Feed Pumping
- Chemical Metering in Manufacturing Applications
- Glue Metering & Manufacturing Applications
- Additive Metering in Lubricant Oil Blending Applications
- Municipal Sewage Treatment Applications

Dimensions ATLAS DOS 11.2

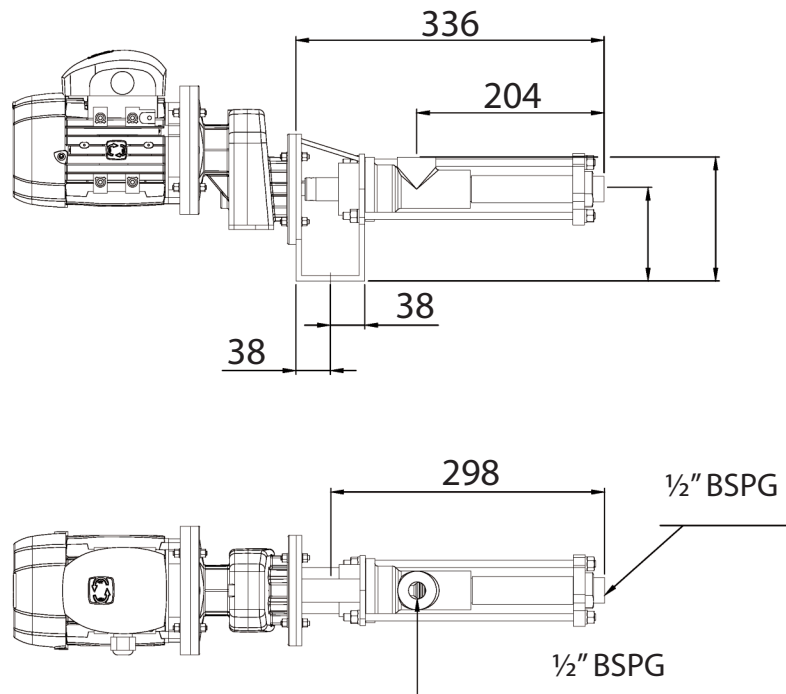

Dimensions ATLAS DOS 12.2

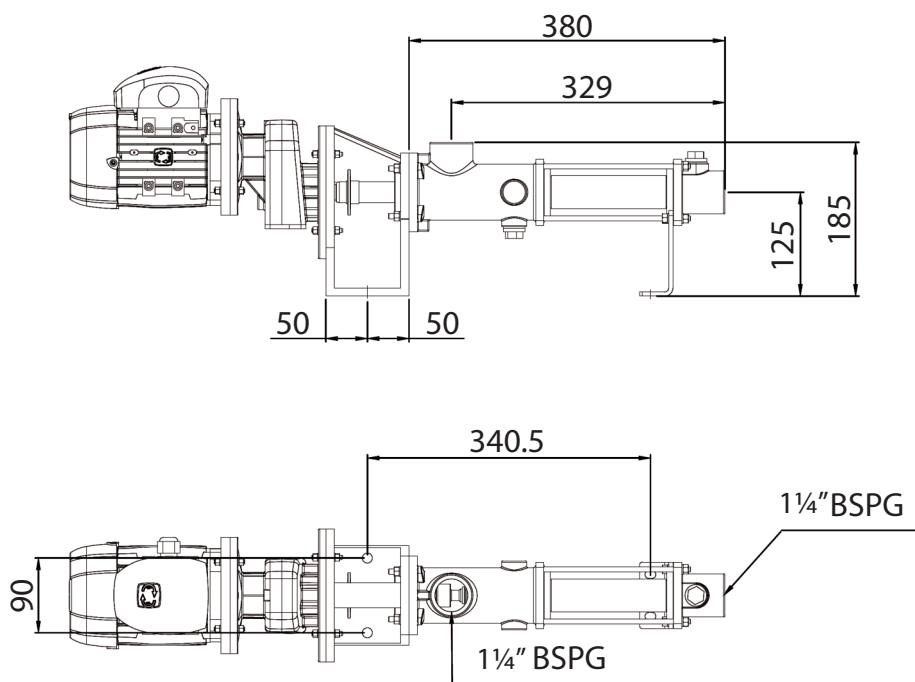



Production Plant - Greece

Inofita Industrial area
59th km Nat.Road Athens- Lamia
GR 320 11 Inofita Viotia, Greece
Tel +30 215 215 9520 , +30 215 215 9580
Email: Sales@alphadynamic.eu
www.alphadynamic.eu

Sales Office – England

Rockleigh House, 37 Burton Road
Ashby de la Zouch , Leicestershire
LE65 2LF - United Kingdom (UK)
Registered in ENGLAND & WALES
Registration number 09706219
Tel +44 1213 680 324 , +44 1213 680472
Email: Sales@alphadynamic.eu
www.alphadynamic.eu